



# Catalogue

## Window reinforcements

As leading manufacturer of steel profiles in Poland, including window reinforcement profiles, **MFO S.A.** is a renowned market player in Europe and overseas. The company owns high capacity storage and production facilities and prides itself on one of the most modern machine parks in Poland. The machine park comprises i.a. three “DREISTERN” production lines with multiple processing stations, including pre- and post- punching systems. The modern machine park and high quality material enable the production of very complicated shapes with the highest qualitative characteristics and dimensional parameters. Our profiles are produced according to individual documentation as prepared by the customer or basing on documentation supplied by our technical department. With our advanced technologies MFO has been able to automate the process of profiles branding and packaging. MFO offers its customers the highest quality products complying with strictest standards, including the EU standards. 2005 the renowned Swiss company SGS accredited by the British UKAS certified MFO with ISO 9001.

[We proudly present a selection from our product range!](#)

# Window reinforcements

## Why do we have a good profile?

### The figures speak for themselves:

- 4 000 000 m of profiles on stock
- 45 000 m<sup>2</sup> of warehousing area
- 15 000 tones of monthly processed steel
- 1600 different shapes in our program
- 670 customers worldwide
- 350 qualified employees
- 50 countries on 6 continents with regular deliveries
- Around the clock production
- 25 account managers at your disposal
- 26 modern production lines
- 4 lines with pre- and post- punching systems
- Market leader in Poland, we work with the biggest window manufacturers in Europe

## Product application

- PVC window and door reinforcements

## Material used for production:

- Galvanised steel for cold processing delivered according to standard PN-EN 10346

## Product range

- Window reinforcements for all PVC window systems on the market: Aluplast, Decco, Deceuninck, Gealan, Profine, Rehau, Salamander, Veka, Wital

## Technology

- R&D department enabling the development of each profile on the individual customer's order.
- We implement an average of 100 per year new profiles

## Quality

- Production according to company system procedures and the strictest European quality standards, including the PN EN ISO 9001, PN EN 10162.
- Quality confirmed by the CSTB institute
- Quality control procedures and the product quality itself is verified by the independent research and certification institute – Zespół Ośrodków Kwalifikacji Jakości Wytrobów SIMPTTEST.
- Material for production is supplied to us by European steel mills, which guarantees the highest quality of the finished products

## We offer

- Complex commercial offer and a broad product range
- Modern machine park
- High quality products renowned on demanding EU-markets
- High storage capacity
- Possibility of quarterly orders, which ensure price stability,
- Availability of material and quick delivery
- Wide geographical diversification of sales both in Poland and abroad

- Logistic experience in national and international transport, also maritime
- Own R&D Department will design profile according to the customer's request.
- Short delivery time

## Our strengths

- For 16 years in a row, Centrum Analiz Biznesowych (CAB) has confirmed our stable leading position in the production of window reinforcements on both domestic and international markets
- Continuous investment in development and machinery: investments 2022-2024: 85-120 million PLN
- Laboratory for hardness testing of steel
- R&D Department

## Additional services

### Adaptation of packaging for automatic systems.

At the customer's request, we are able to adapt the packaging to individual customer preferences:

- package size
- special labels, e.g. RFID
- profile marking

### Cutting service

- Standard 5.85; 6; 6.5 m
- On demand from 0.25 m

### Laser processing and cutting technology

#### – Trumpf TruLaser 5000

- Possibility of cutting shape in the profile – according to the customer's drawing.
- The cut-outs by laser are highly precise and meet the highest standards.
- Steel reinforcement profiles with or without mitre cut

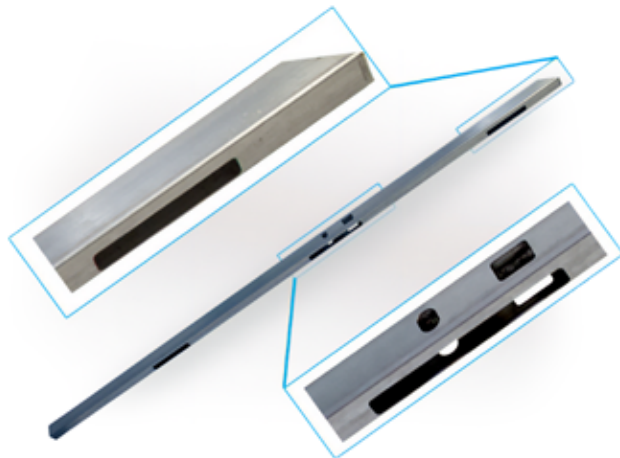

## Product packaging

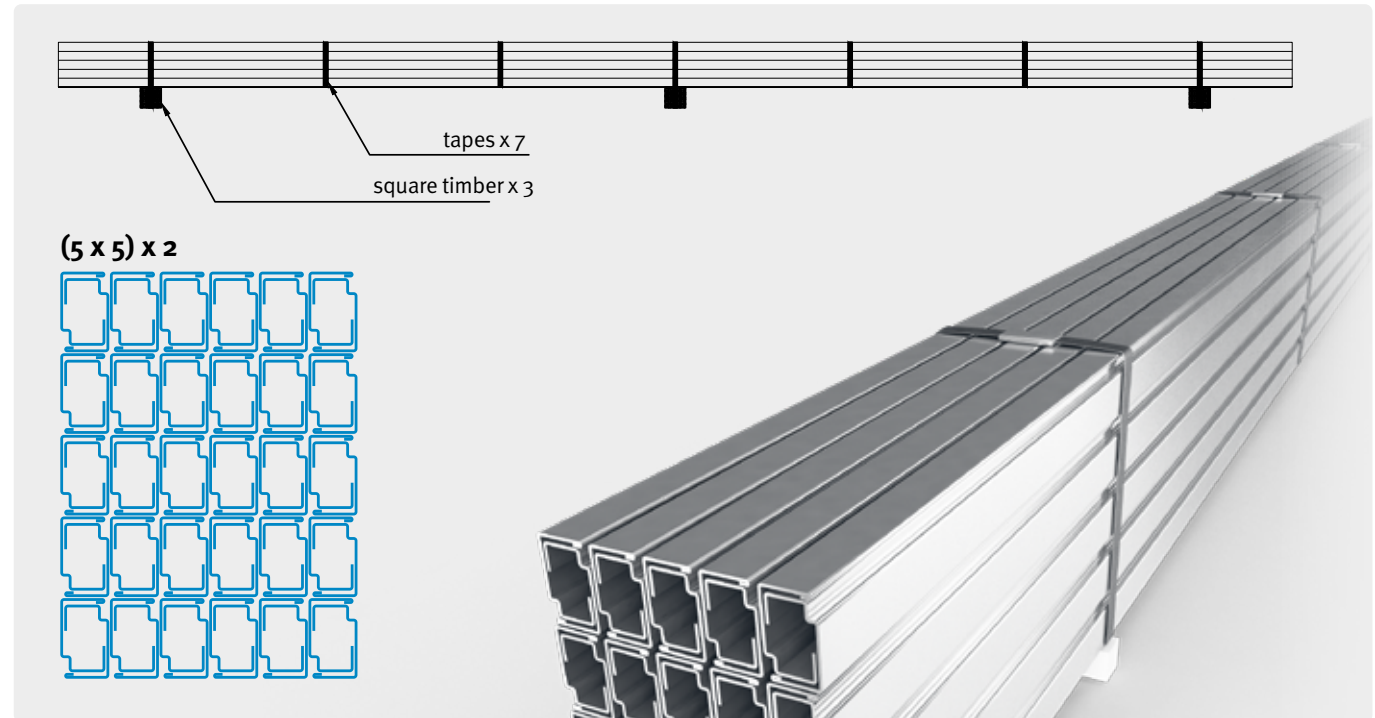

Profiles manufactured by MFO are packed in packages

Materials used for packaging:

- PET tape
- wooden blocks,
- euro pallets
- other packaging materials according to customer's order

# Gealan

**Gealan 6714**

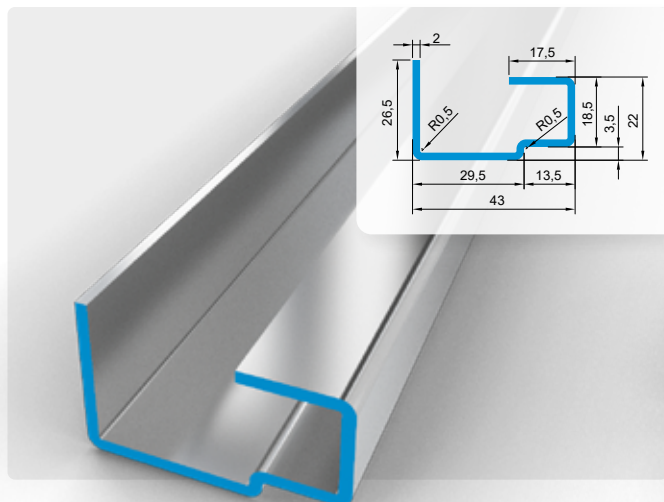

**Gealan 2756**

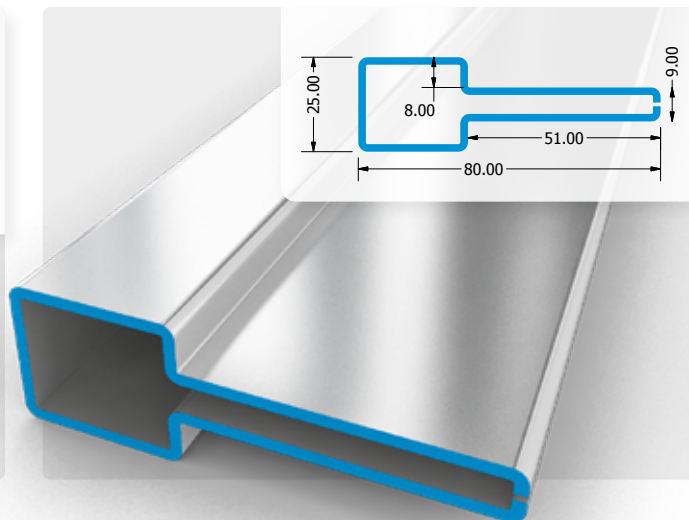

**Gealan 8753**

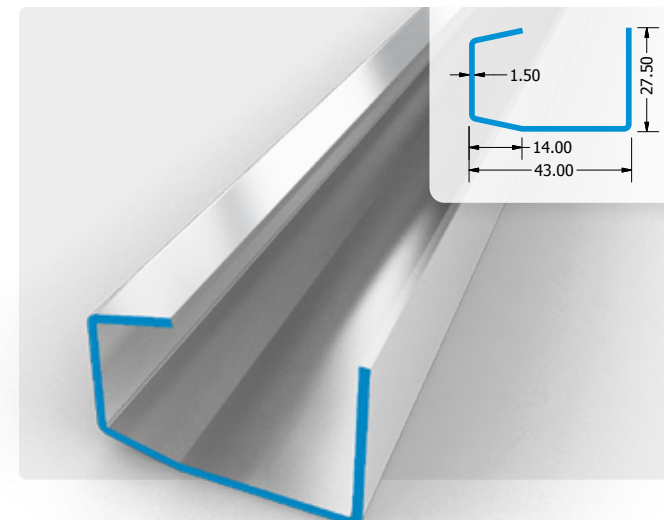

**Gealan 8701**

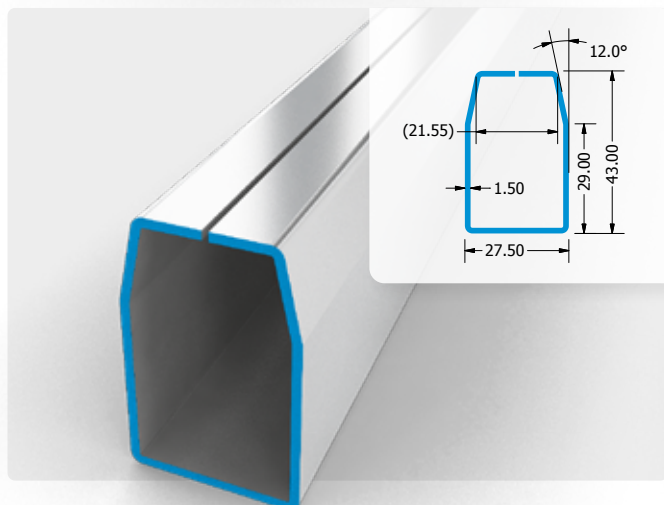

**Gealan 8716**

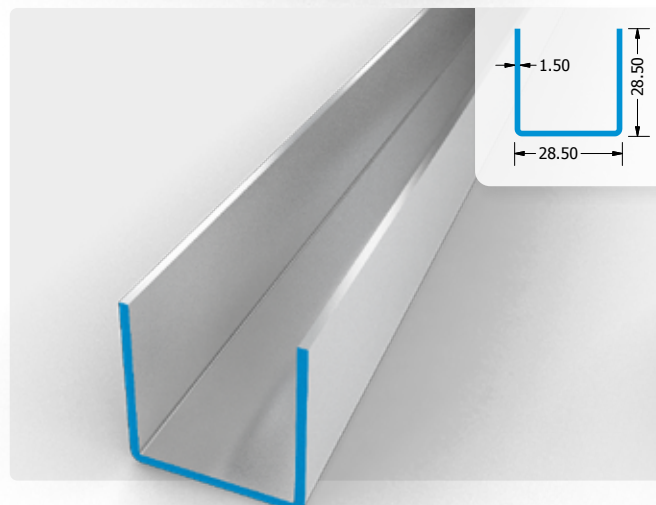

**Gealan 6721**

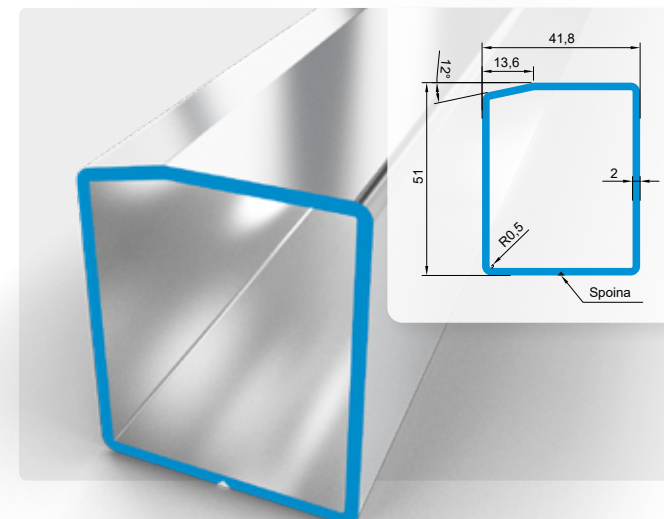

## Gealan

No.	Symbol	Dimensions (mm)	Thickness (mm)
1	2724	20/40	2.00
2	2756	25/80/51/9	2.00
3	4709	46/16.9/8	1.50
4	4712	45.5/41.5/17.5/5.7	1.25
5	4715	35.5/20/8.2/9	1.50
6	5726	22.1/17.5/51.8/10.9	2.00
7	5731	24/46	2.00
8	5733	10.6/43.5	2.00
9	5734	45/46	2.00
10	5737	30.1/43.5	2.00
11	5738	4.3/43.5/46/4.3	2.00
12	5775	45/46	2.50
13	5776	30.5/33.8/30.5	1.50
14	5777	30.5/33.8/30.5	2.00
15	5880	43/33/10.7	2.00
16	5960	20/40	1.50
17	6381	40/55	2.00
18	6386	11/10	1.25
19	6705	26.5/30/26.5	1.50
20	6706	26.5/30/26.5	2.00
21	6708	26.5/26.5/26.5	1.50
22	6709	26.5/26.5	1.50
23	6711	19.5/44	1.50
24	6712	17.5/40	2.00
25	6713	26.5/43/13.5/17	1.50
26	6714	26.5/43/13.5	2.00
27	6716	19/40.5/26/19	2.00
28	6718	26/40.5/19	2.00
29	6737	26.5/26.5	2.00
30	6744	17.5/28	1.50
31	6750	32/58	2.00

No.	Symbol	Dimensions (mm)	Thickness (mm)
32	7703	26.5/30/31.9	2.00
33	7718	50/50	2.00
34	7735	25/40/25	2.00
35	7737	40/40	2.00
36	7738	4.5/39.8/4.5	2.00
37	7742	40/25/18.5	2.00
38	8701	27.5/43	2.00
39	8703	14/43/27.5	2.00
40	8705	25/42.5/40/18	2.00
41	8706	46/48.5/20	2.00
42	8713	34/49	2.00
43	8715	28.5/28.5	1.50
44	8716	28.5/28.5/28.5	1.50
45	8724	46/19.5/14/8	2.00
46	8727	28.5/28.5/28.5	2.00
47	8741	39.8/28.5/28.5/27.4	2.00
48	8751	27.5/43	1.50
49	8753	14/43/27.5	1.50
50	8757	27.5/30/43/14.5/24.5	1.50
51	8759	39.8/28.5/28.5	2.00
52	8760	30/19.9/15.9/20.4	1.50
53	8765	39.8/28.5/28.5	1.50
54	8770	23.5/30	1.50
55	8779	45.9/17.6/5/8.2	1.25
56	6721	51/41.8/13.6	2.00
57	6722	51/41.8/13.6	2.00
58	7731	40/25	1.50
59	7732	40/25	2.00
60	8736	60/46	2.00
61	8737	60/46	2.00





Certificate PL21/1530

The management system of

**MFO S.A.**Kobuski Parcel 70A, 96-500 Sochaczew, PL  
has been assessed and certified as meeting the requirements of**ISO 45001:2018**For the following activities  
Distribution of metallurgical products and production and distribution of silt steel coils, coils

This certificate is valid from 21 February 2024 until 20 February 2027 and remains valid subject to Issue 2. Certified since 21 February 2021

Certified activities performed by additional sites are listed on subsequent pages.

Authorized by  
Jonathan Hall  
Global Head - Certification ServicesSGS United Kingdom Ltd  
Rosemore Business Park, Ellesmere Port, Cheshire, CH65 3EN, UK  
t +44 (0)151 350-6666 - www.sgs.com

This document is an authentic electronic certificate for Client's business purposes use only. Printed version of the electronic certificate copy. This document is issued by the Company subject to SGS General Conditions of certification services available on Terms of certification of liability, indemnification and jurisdictional clauses contained therein. This document is copyright protected and any use of the content or appearance of this document is unlawful.

Page 1 / 2

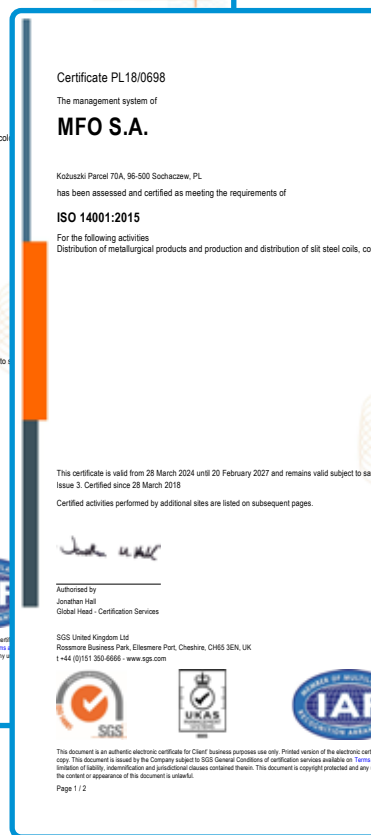

Certificate HU09/3967

The management system of

**MFO S.A.**Kobuski Parcel 70A, 96-500 Sochaczew, PL  
has been assessed and certified as meeting the requirements of**ISO 9001:2015**For the following activities  
Distribution of metallurgical products and production and distribution of silt steel coils, coils

This certificate is valid from 15 April 2024 until 20 February 2027 and remains valid subject to Issue 6. Certified since 15 April 2009

Certified activities performed by additional sites are listed on subsequent pages.

Authorized by  
Jonathan Hall  
Global Head - Certification ServicesSGS United Kingdom Ltd  
Rosemore Business Park, Ellesmere Port, Cheshire, CH65 3EN, UK  
t +44 (0)151 350-6666 - www.sgs.com

This document is an authentic electronic certificate for Client's business purposes use only. Printed version of the electronic certificate copy. This document is issued by the Company subject to SGS General Conditions of certification services available on Terms of certification of liability, indemnification and jurisdictional clauses contained therein. This document is copyright protected and any use of the content or appearance of this document is unlawful.

Page 1 / 2

